

Online Field Mounted pH ORP Indicating Transmitter – 2 Wire

MS pH 211 T



FEATURE

- Online Measurement
- Auto / Manual Temp Compensation
- 4-20 mA DC Output
- On-Line Indication through LCD Display
- Simple operating interface
- 2 Wire System
- Easy Installation

DESCRIPTION

MicroSet pH Indicating Transmitter Model MS pH 211 T is used for various industrial applications. MS pH 211 T is a convenient and cost-effective solution for monitoring and transmitting pH or ORP value. It can accept input from any pH or ORP sensor. MS pH 211 T output is in the form of Analogue 4-20 mA DC two wire.

PRINCIPLE

Why pH Measurement is required?

To check the acidic or alkaline nature of aqueous solution. pH (Potential Hydrogen) is unit of measurement, used to determine the Acidity or Alkalinity of an aqueous solution. Practical pH scale for industrial instrumentation ranges from 0 to 14 pH. The acidic substances range from 0 to 6 and on the other end are the alkaline substances, which range from 8 to 14, with pH 7 being neutral, this is the pH of pure water which is neither very acidic nor very alkaline, is said to be neutral.

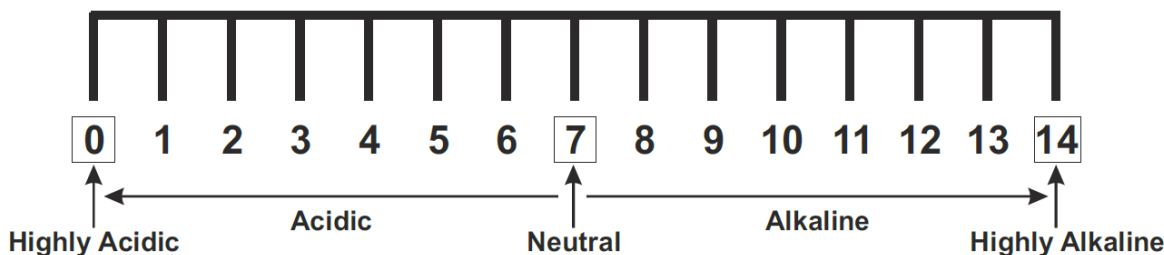

How pH is measured?

Although everyone is familiar with Litmus paper, the only reliable way to measure pH is using Potentiometric Combination electrodes. These electrodes develop a millivolts output corresponding to pH value of solution which is directly proportional to the Free Hydrogen ion concentration in an aqueous Solution. These generated raw mill volts are fed to MS pH 211 T where it is processed by amplifier & reading is displayed on meter

TECHNICAL SPECIFICATION

Type of Input	: From pH or ORP Electrode (Compatible to any make Electrode)
Type of Output	: 4 - 20 mA
Display	: LCD Display
Calibration Range	: pH : 0 to 14 pH, ORP : $\pm 2000\text{mV}$
Calibration Points	: 3 Point
Temp Compensation	: RTD PT-100 / RTD PT-1000
Accuracy	: pH : ± 0.01 pH, ORP : $\pm 3\text{mV}$
Isolation	: 1.4 KV between Input, Output & Power Supply
Sensor Connection	: Through Terminals
Power Supply	: 24V DC Two Wire Loop Powered
Power Consumption	: < 50 mW
Repeatability	: $\pm 0.05\%$ of Span, at 25°C
Response Time	: < 1000 mSec
Temp Coefficient	: $\pm 0.05\%$ per °C
Electronic Protection	: Weather Proof IP 67
Dimensions	: 155 mm (H) x 105 mm (W) X 130 mm (D)
Electrical Connections	: M20X1.5 (F)
Mounting	: 2" Pipe Mounting (2" U Clamp with Mounting Bracket Included)
Weight	: 1 kg (Approximate)
Ambient Conditions	: Temperature -20 to 55 °C / Humidity 5 to 95% Non-condensing
Housing MOC	: Cast aluminum with epoxy coating NEMA 4X

APPLICATION

Water Treatment Plant (WTP)	Wastewater Treatment Plant (WWTP)
Effluent Treatment Plant (ETP)	Sewage Treatment Plant (STP)
RO Water Plant	Power Plant
Hydroponics	Chemical Industry
Textile Industry	Paper & Pulp
Beverages / Food Industry	Pharma Industry
Scrubber Application	Pigment Industry
Steel Industry	Aqua Culture

INSTALLATION DIAGRAM

PIPE MOUNTED

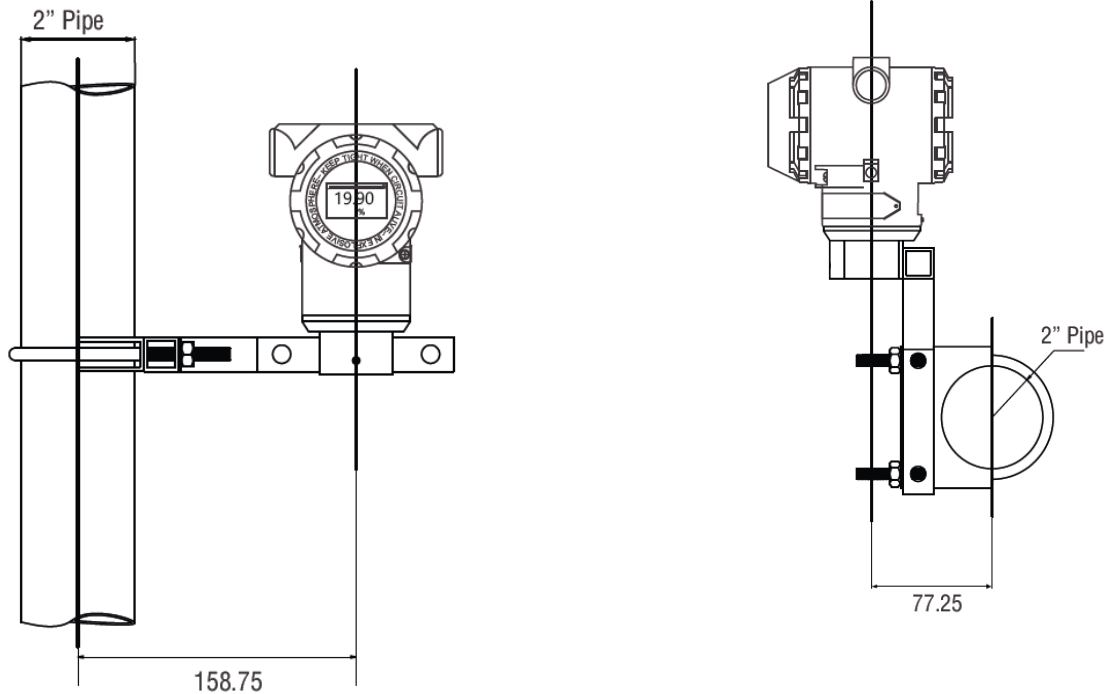

WALL MOUNTED

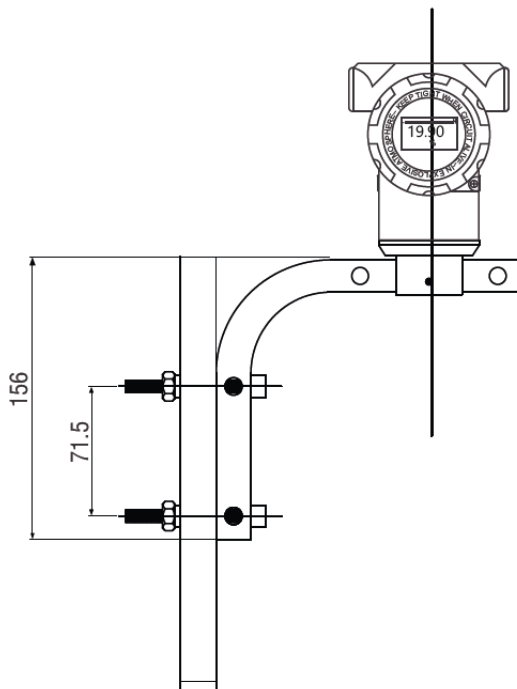

Note : Due to Continuous Improvement, Specifications & Appearance may vary